

State of South Carolina (6)

Pursuant to a warrant

issued from Wm Thomas
Com. Lot for Greenville
Dist. in the State of S.C.
dated the 29th Aug. 1810

I have admeasured &
laid out into George
Ross a tract of fifty
four acres of land
situate in the State
& District aforesaid
said, between
Enoree River &
Breeshy creek,

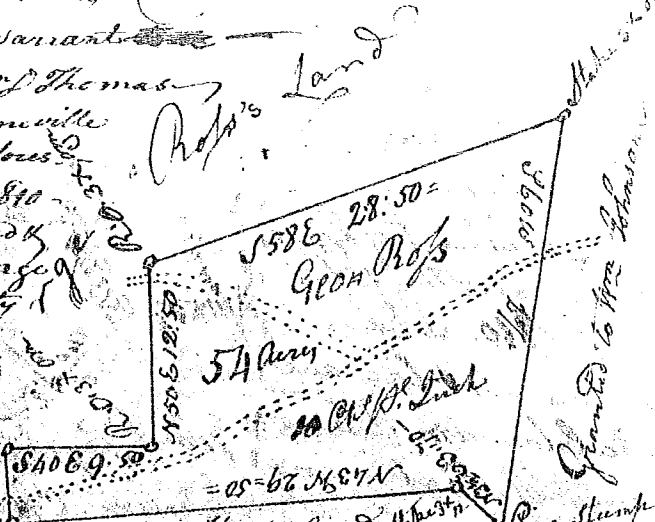

bound by lines
run. S. by land granted to Wm Johnson N.W. by Thomas Humps
land & all other sides by said George Ross's land, & hath such
shape marks, bearings and boundings as the above plat represents.

Survey'd the 15th August 1810
Recorded 11th Sept 1810

John Kilgore Dist. D.

S. Carolina

Pursuant to a
warrant from
W. D. Thomas

Com. Lot dated the
24th July 1810. I
have admeasured
& laid out into
Jesse Griffin about
of eighty four acres
of land. Situate
lying & being in
Greenville District



on both sides of Grand Branch the waters of Enoree
river, bounded to the N.W. by Barry land E. by land
granted to John Anderson to the S. & W. by land
granted to Jesse Griffin & hath such form & marks
as the above plat represents.

Survey'd the 25th July 1810

Recorded the 15th Sept. 1810 = John Young Dist. D.